

**KETTERING BOROUGH COUNCIL**  
**(OFF-STREET PARKING PLACES)**  
**ORDER 2020**

Kettering Borough Council (hereinafter called "the Council") in exercise of its powers under Sections 32, 35(1) and (3), 3(A), 35A, 35B and Part IV of Schedule 9 of the Road Traffic Regulation Act 1984, as amended ("the 1984 Act") and of all other enabling powers, after consultation with the Chief Constable of Northamptonshire Police in accordance with Part III of Schedule 9 to the 1984 Act hereby makes the following Order:

**PART 1**  
**GENERAL**

**Commencement and Citation**

1. This Order shall come into operation on the 6<sup>th</sup> day of November 2020 and may be cited as Kettering Borough Council (Off-Street Parking Places) Order 2020.

**Interpretation**

2. In this Order, except where explicitly stated, any reference in this Order to a numbered Article shall be construed as a reference to the Article bearing that number in this Order. Any reference in this Order to a Part is a reference to a Part of this Order and any reference to a Schedule is a reference to a Schedule to this Order.
3. In this Order, except where the context requires otherwise, the words and expressions in Schedule 1 shall have the meanings assigned to them in that Schedule.
4. Any reference in this Order to any enactment shall be construed as a reference to that enactment as amended, applied, consolidated, re-enacted by or as having effect by virtue of any subsequent enactment.

5. Unless the context otherwise requires, words denoting the singular shall include the plural and vice versa. Words denoting persons shall include either gender, bodies corporate, unincorporated associations and partnerships.
6. The Interpretation Act 1978 shall apply for the interpretation of this Order as it applies for the Interpretation of an Act of Parliament.

## **PART 2**

### **DESIGNATION AND USE OF PARKING PLACES**

#### Designation

7. Each area of land or building named in Schedule 2 and as shown on the plans in Schedule 9 may be used as a place to park vehicles subject to the conditions set out in this Order.

#### On entering the parking place

8. On entering the parking place the driver must proceed without undue delay to park in a parking bay appropriate for their intended stay and must remain parked in that parking bay until the vehicle leaves the parking place.

#### Class of vehicle

9. Where a parking place in Schedule 2 or a parking bay in Schedule 6 is described as available only for vehicles of a specified class and this is signed at the parking place then no person shall cause or permit a vehicle to be parked within that parking place or parking bay unless it is of the class specified.

#### Position of vehicle

10. If parking bays are marked-out in a parking place the driver of a vehicle shall ensure this it is not parked beyond the parking bay markings.

11. A vehicle will not be parked in contravention of this Order if the vehicle is parked within a parking place but beyond bay markings if a vehicle is continuously being used for an activity set out in Schedule 7.
12. Whether or not parking bays are marked out in a parking place the driver of a vehicle shall ensure that it is positioned so that it does not obstruct other vehicles using the parking place, the free flow of traffic circulating within the parking place or the entrances to and exits from the parking place.

#### Days and Hours of operation

13. No person shall cause or permit a vehicle to be parked in a parking place or parking bay outside the days and hours set out in Schedule 2 and Schedule 6 respectively and as signed at the parking place.

#### Maximum stay

14. Where in Schedules 3 and 4 or in Schedule 6 and as signed at the parking place a parking place or parking bay is described as being limited to a maximum period of stay, no person shall cause or permit a vehicle to be parked in that parking place or parking bay for any period longer than that specified.

#### The requirement to vacate

15. Where in Schedules 3 and 4 or in Schedule 6 and as signed at the parking place a parking place or parking bay is described as needing to be vacated by a specified time, no person shall cause or permit a vehicle to be parked in that parking place or parking bay after the time specified.

#### Period of no return

16. Where in Schedules 3 and 4 or in Schedule 6 and as signed at the parking place a parking place or parking bay is described as having a period within which a vehicle may not return, no person shall cause or permit a vehicle to be parked again in that parking place or parking bay

during the time for which the vehicle is excluded from being parked in the parking place or parking bay.

**Power to close or suspend parking places**

17. Nothing in this Order shall prevent the Council by notice, sign or barrier displayed or erected in a parking place from closing a parking place or any part or parts thereof for any period.
18. Nothing in this Order shall prevent the Council by notice, sign or barrier displayed or erected in a parking place from suspending the use of a parking place or any part or parts thereof on certain days or during certain parts of days to be set aside for use only by particular vehicles or organisations.
19. Any person closing or suspending the use of a parking place or any part thereof shall thereupon place or cause to be placed in or adjacent to that parking place or that part thereof a notice or traffic sign indicating that the parking place or that part thereof is closed or the use is suspended and parking by vehicles is prohibited.
20. No person shall without the authority of the Council cause or permit a vehicle to be parked in a parking place or any part thereof during such periods that the parking place or that part thereof is closed or the use is suspended.

**Sale of Goods**

21. No person shall in a parking place without the express written permission of the Council use a vehicle in connection with the sale of any article, including the vehicle itself, to any person in or near the parking place or in connection with the selling or offering for hire of skill or services in any other capacity.

Parked with engine running

22. No person shall in a parking place continue to run the engine when the vehicle is in the parking place and shall not start the engine except when about to change the position of the vehicle in or to depart from the parking place.

**PART 3  
PAYMENT FOR PARKING**

The requirement to pay

23. Unless an exemption set out in Part 4 applies, no person shall cause or permit any vehicle to be parked in a parking place during the chargeable days and hours set out Schedules 3 and 4 without payment of the applicable parking charge as set out in those Schedules.
24. If at any time while a vehicle is parked in a parking place no pay-and-display ticket is displayed on that vehicle and no valid alternative payment method is in place in accordance with the provisions of this Order it shall be deemed that the parking charge has not been paid.

Pay-and-display payment

25. On parking the vehicle in a parking bay the driver of the vehicle shall without undue delay arrange for the purchase of a pay-and-display ticket from a ticket machine situated at that parking place for the period required in accordance with the charges specified in Schedules 3 and 4.
26. The driver of the vehicle shall ensure that a valid pay-and-display ticket is displayed in the relevant position in the vehicle in respect of which it was issued at all times the vehicle is parked.
27. A pay-and-display ticket is not transferable from one vehicle to another and on transfer the pay-and-display ticket ceases to be valid.

28. A pay-and-display ticket is valid only in the parking place in which it was issued. In all cases pay-and-display tickets shall only be valid for the period for which payment was made.
29. The expiry of the period for which the parking charge has been paid shall be when the time shown on the clock of the issuing ticket machine is later than the expiry time shown on the pay-and-display ticket displayed.

#### Alternative payment methods

30. The Council may make available one or more alternative payment methods which can be used instead of pay-and-display. These may be provided by the Council or through a third party and will be advertised in the parking place.
31. Payment by alternative payment method shall have equal validity to the purchase of a pay-and-display ticket providing all applicable conditions are met.
32. The parking charges set out in Schedules 3 and 4 are equally applicable for an alternative payment method but a provider may make additional charges for the services they provide.
33. Other than the requirement to purchase a pay-and-display ticket the driver of the vehicle must comply with all other provisions in this Order.

#### Ticket machine out-of-order

34. If when the vehicle is initially parked in a parking place the ticket machine nearest to the vehicle is out-of-order then a ticket shall be obtained from another ticket machine within the same parking place (where provided).
35. If when the vehicle is initially parked in a parking place there is no ticket machine at the parking place or all ticket machines at that parking

place are out-of-order the driver of the vehicle shall be exempt from purchasing a pay-and-display ticket but is required to adhere to all other requirements in this Order.

## **PART 4 EXEMPTIONS**

### **Disabled Person's Badge**

36. A vehicle parked in a disabled person's parking bay or general bay which displays in the relevant position a valid disabled person's badge is exempt from the parking charge, provided that immediately before or after the act of parking the vehicle has been used or is about to be used by the person(s) in respect of whom the badge is issued.

### **Motorcycles**

37. A motorcycle parked in a motorcycle bay or general parking bay is exempt from the parking charge.

### **Police vehicles**

38. A police vehicle parked wholly within a police bay is exempt from the parking charge.

### **Electric vehicles**

39. An electric vehicle parked in an electric vehicle charging bay is exempt from the parking charge while charging the vehicle up to the maximum period of time as set out in Schedules 3 and 4 and as signed at the parking place.

### **Season tickets**

40. A vehicle parked in a general parking bay displaying a valid season ticket issued by the Council for that parking place is exempt from the parking charge.

41. A season ticket can be purchased from the Council for the charges set out in Schedule 5.
42. A season ticket is only valid in the parking place(s) in respect of which it was issued, for the vehicle(s) in respect of which it was issued and up to the date of expiry shown on the season ticket.
43. A season ticket shall be displayed in the relevant position on a vehicle in respect of which it was issued at all times during which the vehicle is parked in the parking place.
44. All provisions in this Order remain other than the requirement to pay.
45. The Council may withdraw or refuse to renew a season ticket if the Council is satisfied that a season ticket has been used contrary to the issuing conditions.
46. The Council may decline to issue any further season tickets or may request at any time that any or all current season tickets are surrendered.
47. A refund for unused eligibility may be requested by the season ticket holder by returning the season ticket to the Council.
48. The date used for the evaluation of a refund request will be the date that the returned season ticket is received by the Council.
49. The amount of any refund would be evaluated on the basis of wholly unused months, calculated on a pro rata basis.
50. If the Council instructs that the season ticket is to be surrendered then a partially used month would also be refunded on a pro rata basis.

#### Parking permits

51. A vehicle parked in a parking place displaying a valid parking permit issued by the Council to allow parking in that parking place is exempt from the parking charge.



52. A parking permit is provided by the Council for a specific vehicle subject to conditions set out by the Council at the time of issue.
53. A parking permit is only valid in the parking place(s) in respect of which it was issued up to the date of expiry shown on the parking permit.
54. The driver shall abide by the terms stipulated by the Council for the use of the parking permit.
55. Unless explicitly stated otherwise, a parking permit may only be used to park in general parking bays.
56. A parking permit shall be displayed in the relevant position on the vehicle in respect of which it was issued at all times during which the vehicle is parked in the parking place.

#### Exempt activities

57. Any vehicle being actively used for one of the activities set out in Schedule 7 is exempt from the parking charge while that activity is being carried out.

## **PART 5 RELOCATION, REMOVAL AND DISPOSAL OF VEHICLES**

#### Emergencies

58. A person authorised by the Council or a police officer in uniform may, using such measures as are appropriate, move or cause to be moved in the case of an emergency to any place he/she thinks fit, any vehicle parked in a parking place.

#### Contraventions in suspended parking place

59. A person authorised by the Council may, using such measures as are appropriate, move or cause to be moved to any place he/she thinks fit,

any vehicle parked in a parking place which has been closed or suspended in whole or in part by the Council and the cost of movement or removal and safe keeping shall be the liability of the owner of the vehicle.

#### Safe keeping

60. Any person removing a vehicle from a parking place under the provisions of this Order shall make such arrangements as may be reasonably necessary to provide for the safe keeping of the vehicle.

#### Disposal of vehicles abandoned in parking places

61. The Council may sell or otherwise dispose of, in accordance with current legislation, a vehicle which has been, or could at any time be, removed from a parking place if the vehicle appears to have been abandoned.

### **PART 6**

#### **CONTRAVENTION AND PENALTY CHARGE**

#### Contravention

62. Save for the provisions in Part 7, if a vehicle is parked in a parking place without complying with the requirements of this Order, a contravention shall have occurred and a penalty charge shall be payable. A penalty charge notice may then be issued and served and/or the vehicle may be removed from its location. All enforcement action shall be in terms of legislation and subsequent amendments.

#### Restriction on removal of notices

63. Any notice, including a penalty charge notice, fixed to a vehicle in accordance with this Order shall not be removed or interfered with except by or under the authority of:
- (i) the Owner or driver of the vehicle;
  - (ii) the Council for the parking place in which the vehicle in question was parked.

Indications as evidence

64. The particulars given in any notice served on a vehicle in accordance with the provisions of this Order shall be treated as evidence in any proceedings relating to failure to pay the penalty charge.

**PART 7**

**LIABILITY AND OTHER PROVISIONS**

Liability

65. The Council accepts no liability for the loss or damage to vehicles or other property left in any of the parking places to which this Order applies save for that arising from the negligence of the Council.

Validity

66. If a court or The Traffic Penalty Tribunal declares any part of this Order to be invalid or un-enforceable, such declaration shall not invalidate the remainder of the Order.

Tax and Insurance

67. Any person who causes or permits any vehicle to wait in a parking place without the vehicle being licensed in pursuance of the provisions of the Vehicles Excise and Registration Act 1994 and without a current policy of insurance in relation to the use of the vehicle by the driver such as complies with the requirements of Part VI of the Road Traffic Act 1972 shall be liable to prosecution.

Driving within a parking place

68. Where in a parking place signs are erected or surface markings are laid for the purpose of
- (i) indicating the entrance to or exit from the parking place, or
  - (ii) indicating that a vehicle using the parking place shall proceed in a specified direction within the parking place,
- any person who drives or permits to be driven any vehicle
- (i) so that it enters the parking place otherwise than by an entrance,
- or

- (ii) leaves the parking place otherwise than by an exit so indicated,  
or
  - (iii) in a direction other than so specified
- shall be liable to prosecution.

69. Any person who, without with the permission of a person authorised by the Council in that behalf, drives or permits to be driven any vehicle in a parking place for any purpose other than the purpose of leaving that vehicle in the parking place in accordance with the provisions of this Order or for the purpose of departing from the parking place shall be liable to prosecution.

#### Wilful damage

70. Any person who with intent to defraud interferes with a ticket machine or operates or attempts to operate it by the insertion of objects other than undamaged and unaltered coins of legal tender and of the appropriate denomination, shall be liable to prosecution.
71. No person shall cause damage to any Council equipment, signing or lighting installations or other installations within the parking place or to any part of the fabric of the parking place and any person doing so shall be liable to prosecution.

#### Domestic purposes

72. Any person who uses any part of the parking place or any vehicle parked in a parking place
- (i) for sleeping or camping or cooking, or
  - (ii) for the purpose of servicing or washing any vehicle or part thereof other than is reasonably necessary to enable the vehicle to depart from the parking place
- shall be liable to prosecution.

### Behaviour

73. Any person who wilfully sounds any horn or any other similar instrument on a vehicle except when about to change the position of the vehicle in or to depart from the parking place shall be liable to prosecution.
74. Any person who in a parking place shouts or otherwise makes any loud noise to the disturbance or annoyance of users of the parking place or residents or premises in the neighbourhood shall be liable to prosecution.
75. Any person who in a parking place uses any threatening, abusive or insulting language, gesture or conduct with intent to put any person in fear or so as to occasion a breach of the peace or whereby a breach of the peace is likely to be occasioned shall be liable to prosecution.

### Other activities

76. Any person who in a parking place
- (i) erects or causes or permits to be erected any skip, tent, booth, stand, building or other structure without the written consent of the Council, or
  - (ii) lights or causes to be lit any fire, or
  - (iii) conducts activities that do not relate directly to the parking of a vehicle in the parking place under the terms of use of the parking place
- shall be liable to prosecution.

## **PART 8**

### **REVOCATIONS**

#### Revocations

77. The Orders set out in Schedule 8 are hereby revoked.

**EXECUTED as a Deed by affixing the COMMON SEAL  
of Kettering Borough Council**

**In the presence of**



~~Chief Legal Officer Democratic and Legal~~  
~~EXECUTIVE DIRECTOR~~

0106/20

**Dated**

## **SCHEDULE 1 – DEFINITIONS**

<b>Category</b>	<b>Word or Expression</b>	<b>Definition</b>
	Council plans	Kettering Borough Council or its successor authority the plans in Schedule 9 to this Order and which identify parking places affected by this Order
<b>Miscellaneous</b>	parking place	an area of land shown edged in red on the plans at Schedule 9 provided by the Council pursuant to Section 32 of the 1984 Act for the purpose of the parking of vehicles
	parking bay	an area of a parking place which is provided for the leaving of a vehicle of a class specified and indicated by signing and/or markings
	vehicle	any motor car, motorcycle or other mechanically propelled automobile
<b>Vehicle Types - General</b>	motor car	a vehicle (other than a motorcycle or motorhome) constructed or adapted solely for the carriage of not more than twelve passengers (exclusive of the driver) and their effects and not drawing a trailer
	light goods vehicle	a commercial carrier vehicle with a gross vehicle weight of no more than 3.5 tonnes
	motorcycle	a solo motorcycle only and excludes any motorcycle which has a side-car or trailer, or which has more than two wheels
	electric vehicle	a plug-in electric vehicle or a plug-in hybrid electric vehicle
	plug-in electric vehicle	a vehicle which utilises rechargeable batteries or another energy storage device that can be restored to full charge by connecting a plug to an external power source
<b>Vehicle Types - Specific</b>		

	<p>plug-in hybrid electric vehicle</p> <p>motorhome</p> <p>police car</p> <p>trailer</p> <p>special parking bay</p> <p>general parking bay</p> <p>park and parked</p>	<p>an electric drive vehicle using one or more electric motors for propulsion which may also contain a combustion engine either for exclusive use of supplying energy to recharge the power source and/or supplying motive power</p> <p>a vehicle classed as a motorhome by the Driver and Vehicle Licensing Agency</p> <p>a vehicle being used for police purposes or operating under the instructions of a chief officer of police</p> <p>any apparatus drawn by a motor vehicle and for the purposes of this Order shall include a boat or caravan</p> <p>a parking bay which has been designated for specific vehicles or specific purposes as described in Schedule 6 and as signed in the parking place</p> <p>any parking bay within a parking place which is not a special parking bay</p> <p>the stopping of a vehicle and it remaining at rest for some time whether or not the driver is still in the vehicle. A vehicle shall be deemed to be parked for any period in the same parking place or parking bay (as the case maybe) if any part of it is below the vehicle or the vehicle's load (if any) whether or not the vehicle is moved during that period</p>
<p>Bay Types</p>		
<p>Motorist Activities</p>	<p>loading/unloading</p> <p>relevant position</p>	<p>the process of moving items to a vehicle from a premises adjacent to the parking place - or in the opposite direction - where the items are too bulky, numerous or hazardous to</p> <p>the inside surface of the windscreen or in a conspicuous and clearly visible position so that the item is facing forwards and can be easily seen and read from the front or side of the vehicle</p>



	2004 Act	the Traffic Management Act 2004 (as amended)
	driver	the person driving the vehicle at the time it was left in the parking place
Enforcement and Liability	owner	the person who is recorded as the registered keeper of the vehicle by the Driver and Vehicle Licensing Agency on the date on which the vehicle was parked in the parking place in question
	Penalty Charge Notice	a notice issued or served by a person authorised by the Council pursuant to the provisions of part 6 of the 2004 Act
	penalty charge	the charge set by the Council under section 77 of part 6 and schedule 9 of the 2004 Act which is to be paid to the Council following the issue of a Penalty Charge Notice and within the period notified on the Penalty Charge Notice from the date of issue of that Notice
Payment - Days and Hours	bank holiday	has the same meaning as described in the Banking and Financial Dealings Act 1971
	public holiday	means Christmas Day and New Year's Day, or the Monday following Christmas Day and Good Friday where these fall on a Sunday
Payment - Mechanisms	expiry time	the time indicated on the pay-and-display ticket and is the time by which the vehicle must leave the parking place
	pay-and-display ticket	a ticket issued by a ticket machine located in the parking place in which the vehicle has been parked on payment of a charge and valid for a parking period as specified in Schedules 3 and 4

	ticket machine	<p>apparatus designed to indicate the time by a clock and to issue pay-and-display tickets which show that a payment has been made of an amount and/or for a period specified thereon and which specify the date and either the time of such payment or the expiry time of the parking period for which payment has been made</p>
Exemptions	disabled person's badge	<p>any badge issued under any regulations for the time being in force under section 21 of the Chronically Sick and Disabled Persons Act 1970 (as amended)</p>

**SCHEDULE 2 – PARKING PLACES**

<b>Name of Parking Place</b>	<b>Location of Parking Place</b>	<b>Title of Plan of the Parking Place</b>	<b>Classes of vehicle which can be parked in the Parking Place</b>	<b>Days and hours of operation</b>
London Road Car Park	London Road, Kettering, Northamptonshire NN15 6DT	8493: London Road Car Park	Motor car, light goods vehicle, motor cycle	At all times
Commercial Road Car Park	Commercial Road, Kettering, Northamptonshire NN16 8DQ	8494: Commercial Road Car Park	Motor car, light goods vehicle, motor cycle	At all times
Municipal Offices Car Park	London Road, Kettering, Northamptonshire NN15 7QX	8495: Municipal Offices Car Park	Motor car, light goods vehicle, motor cycle	At all times
Queen Street Car Park	Queen Street, Kettering, Northamptonshire NN16 0DW	8496: Queen Street Car Park	Motor car, light goods vehicle, motor cycle	At all times
School Lane Car Park	School Lane, Kettering, Northamptonshire NN16 0DH	8497: School Lane Car Park	Motor car, light goods vehicle, motor cycle	At all times
Wadcroft Car Park	Wadcroft, Kettering, Northamptonshire NN16 8TH	8498: Wadcroft Car Park	Motor car, light goods vehicle, motor cycle	At all times
Council Offices Car Park Burton Latimer	Churchill Way, Burton Latimer NN15 5RX	Churchill Way, Burton Latimer Car Park	Motor car, light goods vehicle, motor cycle	At all times
New Street Car Park	New Street, Desborough NN14 2QZ	New Street, Desborough	Motor car, light goods vehicle, motor cycle	At all times
Church Street Car Park	Church Street, Burton Latimer NN15 5NJ	Church Street, Burton Latimer Car Park	Motor car, light goods vehicle, motor cycle	At all times
Mansefield Close Car Park	Mansefield Close, Desborough NN14 2RA	Mansefield Close, Desborough Car Park	Motor car, light goods vehicle, motor cycle	At all times

Harry Potter House	London Road, Kettering NN15 7QD	Harry Potter House Car Park	Motor car, light goods vehicle, motor cycle	At all times
10 London Road	London Road, Kettering NN157QU	10 London Road Car Park	Motor car, light goods vehicle, motor cycle	At all times
Ebenezer Place Car Park	Ebenezer Place, Kettering NN16 0BF	Ebenezer Place Car Park	Motor car, light goods vehicle, motor cycle	At all times
Chesham House	Lower Street, Kettering NN16 8BH	Chesham House Car Park	Motor car, light goods vehicle, motor cycle	At all times
Rothwell Road, Kettering	Rothwell Road, Kettering NN16 8XE	Rothwell Road Cemetery and Crematoria Car Parks	Motor car, light goods vehicle, motor cycle	At all times
Lake Avenue Car Park	Lake Avenue, Kettering NN15 7RH	Lake Avenue Car Park	Motor car, light goods vehicle, motor cycle	At all times

**SCHEDULE 3 – TARIFF LIST**

<b>Name of Parking Place</b>	<b>Bay Type</b>	<b>Tariff Name</b>
London Road Car Park	General parking bay	A
	Electric vehicle parking bay	F
Commercial Road Car Park	General parking bay	B
	Electric vehicle parking bay	F
Municipal Offices Car Park	General parking bay	C
Queen Street Car Park	General parking bay	D
School Lane Car Park	General parking bay	D
	Electric vehicle parking bay	F
	Pop & Shop bay	E
	General parking bay	D
Wadcroft Car Park	General parking bay	D
Council Offices Car Park Burton Latimer	General parking bay	G
New Street Car Park	General parking bay	G
Church Street Car Park	General parking bay	G
Mansefield Close Car Park	General parking bay	G
Harry Potter House	General parking bay	G
10 London Road	General parking bay	G
Chesham House	General parking bay	G
Ebenezer Place Car Park	General parking bay	G
Lake Avenue Car Park	General parking bay	G
Rothwell Road, Kettering	General parking bay	G

**SCHEDULE 4 – TARIFF TABLE**

<b>Tariff Name</b>	<b>Tariff Description</b>	<b>Chargeable Days and Hours</b>	<b>Parking Charges</b>	<b>Maximum stay and return times in the Parking Place</b>
Tariff A	"London Road"	Monday-Thursday 09:00-15:00 Friday-Saturday 09:00-18:00	Up to 2 hours - £1.50 Up to 3 hours - £3.00 Up to 4 hours - £4.00 Up to 5 hours - £5.00 Over 5 hours - £6.00	No maximum stay
		At other times	No charge	No maximum stay
		Bank Holidays and Public Holidays	No charge	No maximum stay
Tariff B	"Commercial Road"	Monday-Thursday 09:00-15:00 Friday-Saturday 09:00-18:00	Up to 2 hours - £2.00 Up to 3 hours - £3.00 Up to 4 hours - £4.00 Up to 5 hours - £5.00 Over 5 hours - £6.00	No maximum stay
		At other times	No charge	No maximum stay
		Bank Holidays and Public Holidays	No charge	No maximum stay
Tariff C	"Municipal Road"	Monday-Thursday 09:00-15:00 Friday-Saturday 09:00-18:00	Mon-Fri Up to 1 hour - £1.00 Up to 2 hours - £2.00 Up to 3 hours - £3.00 Up to 4 hours - £4.00 Up to 5 hours - £5.00	No maximum stay
		At other times	No charge	No maximum stay
		Bank Holidays and Public Holidays	No charge	No maximum stay

		Over 5 hours - £6.00		
		<u>Saturday</u> Up to 2 hours - £1.50 Up to 3 hours - £3.00 Up to 4 hours - £4.00 Up to 5 hours - £5.00 Over 5 hours - £6.00		No maximum stay
	At other times	No charge		No maximum stay
	Bank Holidays and Public Holidays	No charge		No maximum stay
	Monday-Thursday 09:00-15:00 Friday-Saturday 09:00-18:00	Up to 1 hour - £1.00 Up to 2 hours - £2.00 Up to 3 hours - £3.00 Up to 4 hours - £4.00 Up to 5 hours - £5.00 Over 5 hours - £6.00		No maximum stay
	At other times	No charge		No maximum stay
	Bank Holidays and Public Holidays	No charge		No maximum stay
	Monday-Thursday 09:00-15:00 Friday-Saturday 09:00-18:00	Up to 1 hour - £0.40		Maximum stay 1 hour No return within 1 hour
	At other times	No charge		No maximum stay
	Bank Holidays and Public Holidays	No charge		No maximum stay
	Monday-Thursday 09:00-15:00 Friday-Saturday 09:00-18:00	No charge		2 hours maximum stay No return within 2 hours
Tariff D	"Regular"			
Tariff E	"Pop & Shop"			
Tariff F	"Electric Charging"			

				2 hours maximum stay which must not extend past 09:00 No return before 11:00 the same day
	Mon-Sat 07:00-09:00	No charge		No maximum stay
	At other times	No charge		No maximum stay
	Bank Holidays and Public Holidays	No charge		No maximum stay
Tariff G	"Free parking"	No charge		No maximum stay



**SCHEDULE 5 – SEASON TICKETS**

<b>Length of Season Ticket</b>	<b>Charge when making a one-off payment by credit/debit card</b>	<b>Charge when making monthly payments by direct debit</b>
1 Week	£25	Not Available
1 Month	£102	Not Available
3 Months	£288	3 monthly payments of £96 per month
6 Months	£540	6 monthly payments of £90 per month
12 Months	£1,008	12 monthly payments of £84 per month

**SCHEDULE 6 – SPECIAL BAYS**

<b>Bay Type</b>	<b>Classes of Vehicles that may park</b>	<b>Days and hours of operation</b>	<b>Limitations on stay length and return</b>	<b>Conditions</b>
Disabled Person's Parking Bay	Any allowed in that parking place	At all times within the days and hours of operation of the parking place	None	No person shall cause or permit a vehicle to be parked in a parking bay signed as a Disabled Person's Parking Bay unless the vehicle at all times displays the front of a valid disabled person's badge in the relevant position and immediately before or immediately after the act of parking the vehicle has been or is about to be used by the person(s) in respect of whom the disabled person's badge has been issued.
Police Bay	Any allowed in that parking place	At all times within the days and hours of operation of the parking place	None	No person shall cause or permit a vehicle to be parked in a parking bay signed as a Police Bay unless the vehicle is a police vehicle.
Church Bay	Any allowed in that parking place	At all times within the days and hours of operation of the parking place	None	No person shall cause or permit a vehicle to be parked in a parking bay signed as a Church Bay unless the vehicle at all times displays in the relevant position a valid permit for that purpose or is otherwise authorised by the Council to do so.

<b>Mayor's Vehicle Bay</b>	Any allowed in that parking place	At all times within the days and hours of operation of the parking place	None	No person shall cause or permit a vehicle to be parked in a parking Bay signed as a Mayor's Vehicle Bay unless the vehicle at all times displays in the relevant position a valid permit for that purpose or is otherwise authorised by the Council to do so.
<b>Electric Vehicle Charging Bay</b>	Electric vehicles only	At all times within the days and hours of operation of the parking place	As set out in Schedules 3 and 4	No person shall cause or permit a vehicle to be parked in a parking bay signed as an Electric Vehicle Charging Bay unless the vehicle is an electric vehicle and is being charged.
<b>Pop &amp; Shop Bay</b>	Any allowed in that parking place	At all times within the days and hours of operation of the parking place	As set out in Schedules 3 and 4	The display of a disabled person's badge does not remove the requirement to pay the parking charge in a Pop & Shop Bay. Season tickets are not valid in Pop & Shop Bays.
<b>Loading/Unloading Bay</b>	Any allowed in that parking place	At all times within the days and hours of operation of the parking place	Maximum stay 20 minutes. No return within 1 hour	No person shall cause or permit a vehicle to park in a parking bay signed as a Loading/Unloading Bay unless the vehicle is being continuously used for the purpose of loading/unloading.
<b>Motorcycle Bay</b>	Motorcycles only	At all times within the days and hours of operation of the parking place	None	No person shall cause or permit a vehicle to park in a parking bay signed for motorcycles unless the vehicle is a motorcycle.

## **SCHEDULE 7 – EXEMPT ACTIVITIES**

- When the driver of the vehicle is required by law to stop
- When the driver of the vehicle is obliged to stop in order to avoid an accident
- When the driver of the vehicle is prevented from proceeding by circumstances outside his control
- To enable a person to board or alight from the vehicle
- To enable goods to be loaded or unloaded from the vehicle
- To enable the parking place to be used in connection with any of the following:
  - (i) Building, industrial or demolition operations
  - (ii) The removal of any obstruction to traffic
  - (iii) The laying, erection or repair of any sewer, main, pipe or apparatus for the supply of gas, water, electricity or any telecommunication system defined by the Telecommunications Act 1984
  - (iv) Use in the service of any undertaker, the Environment Agency or any public authority in pursuance of statutory powers or duties
  - (v) Use for police, fire brigade or ambulance purposes
  - (vi) Use for the purpose of delivering or collecting postal packets as defined by section 125 of the Postal Services Act 2000
  - (vii) Used for the delivery or collection of money or valuable securities by a vehicle specially equipped or adapted for that purpose
  - (viii) The removal of furniture or household effects to or from a shop, office, depository or dwelling house adjacent to the parking place

**SCHEDULE 8 – REVOCATIONS**

Kettering Borough Council (Off-Street Parking Places) (Civil Parking Enforcement and Consolidation) Order 2020

Kettering Borough Council (Off-Street Parking Places) (Civil Parking Enforcement and Consolidation) (Amendment) Order 2020

**SCHEDULE 9 – PLANS**



**Title: Harry Potter House Car Park**

Reproduced by permission of Ordnance Survey on behalf of HMSO. © Crown Copyright 2020 All rights reserved.

Licence 100017847

Date: 22:01:20

Scale: 1:1000

Drawn by: HGW

**Kettering**  
Borough Council

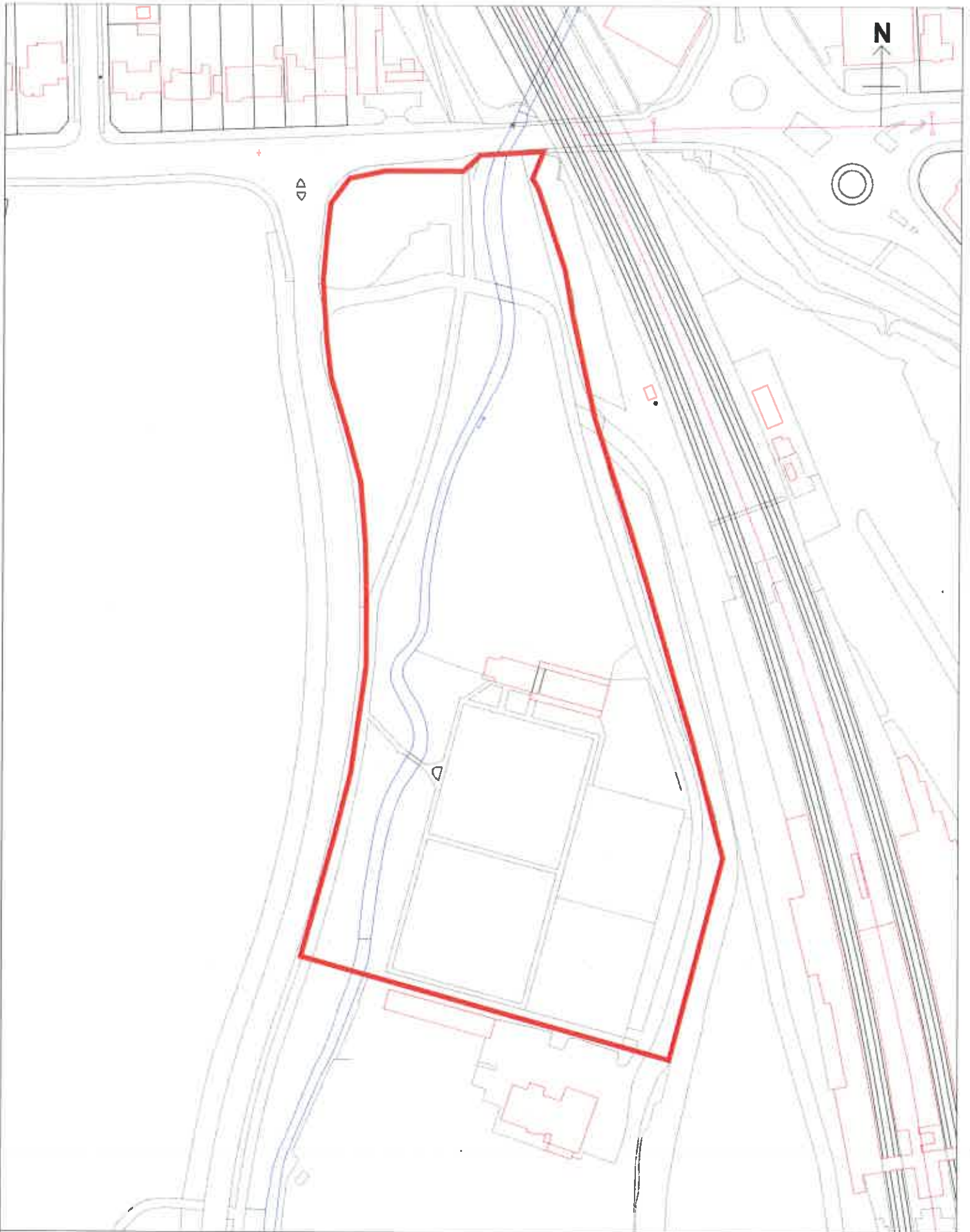

**Title: Lake Avenue Car Park**

Reproduced by permission of Ordnance Survey  
on behalf of HMSO. © Crown Copyright 2020  
All rights reserved.

Licence  
100017647

Date: 22:01:20

Scale: 1:1500

Drawn by: HGW

**Kettering**  
Borough Council



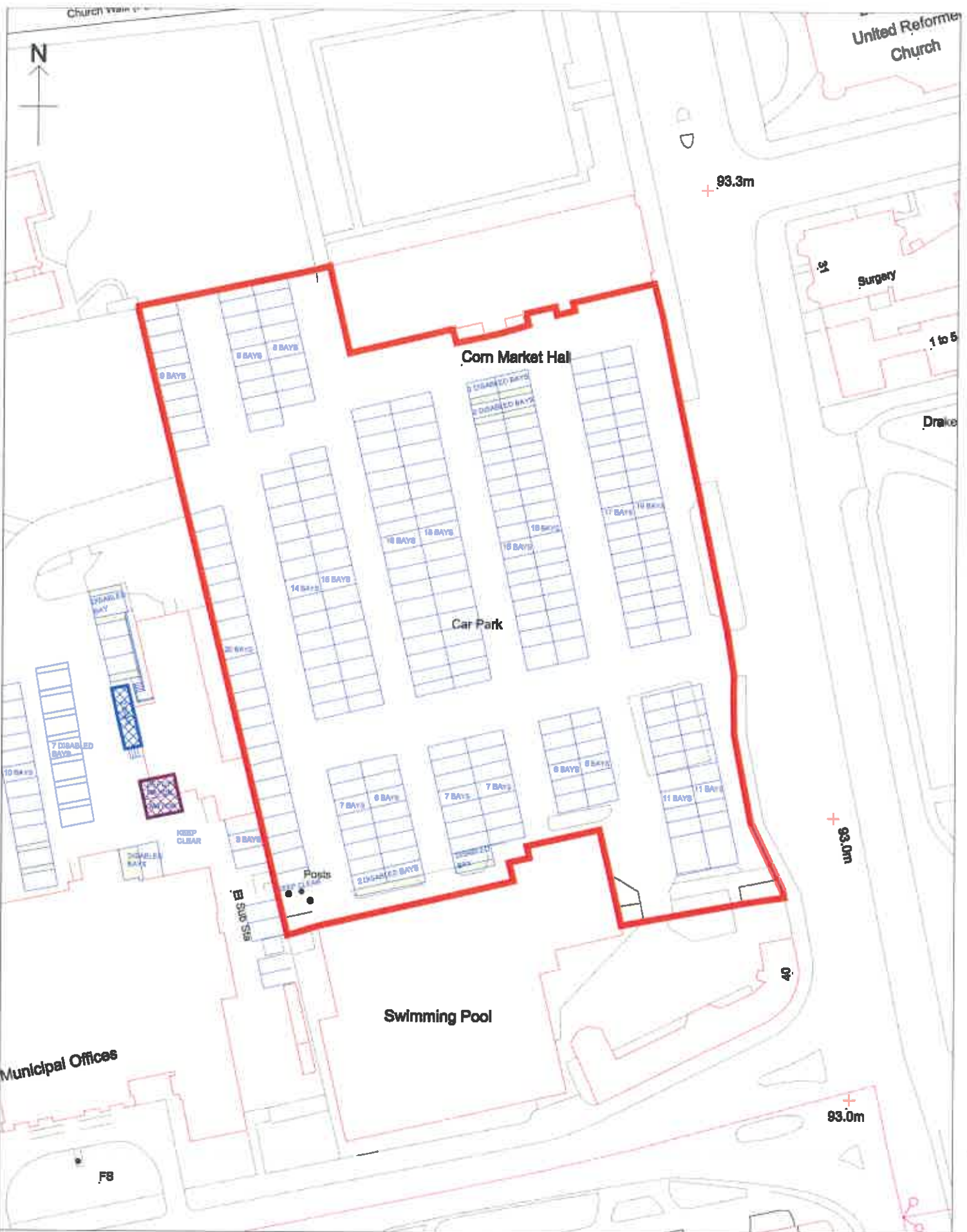

Title: London Road Car Park

Reproduced by permission of Ordnance Survey on behalf of HMSO. © Crown Copyright 2020 All rights reserved.

Licence 100017847

Date: 24:01:20

Scale: 1:750

Drawn by: HGW

**Kettering**  
Borough Council

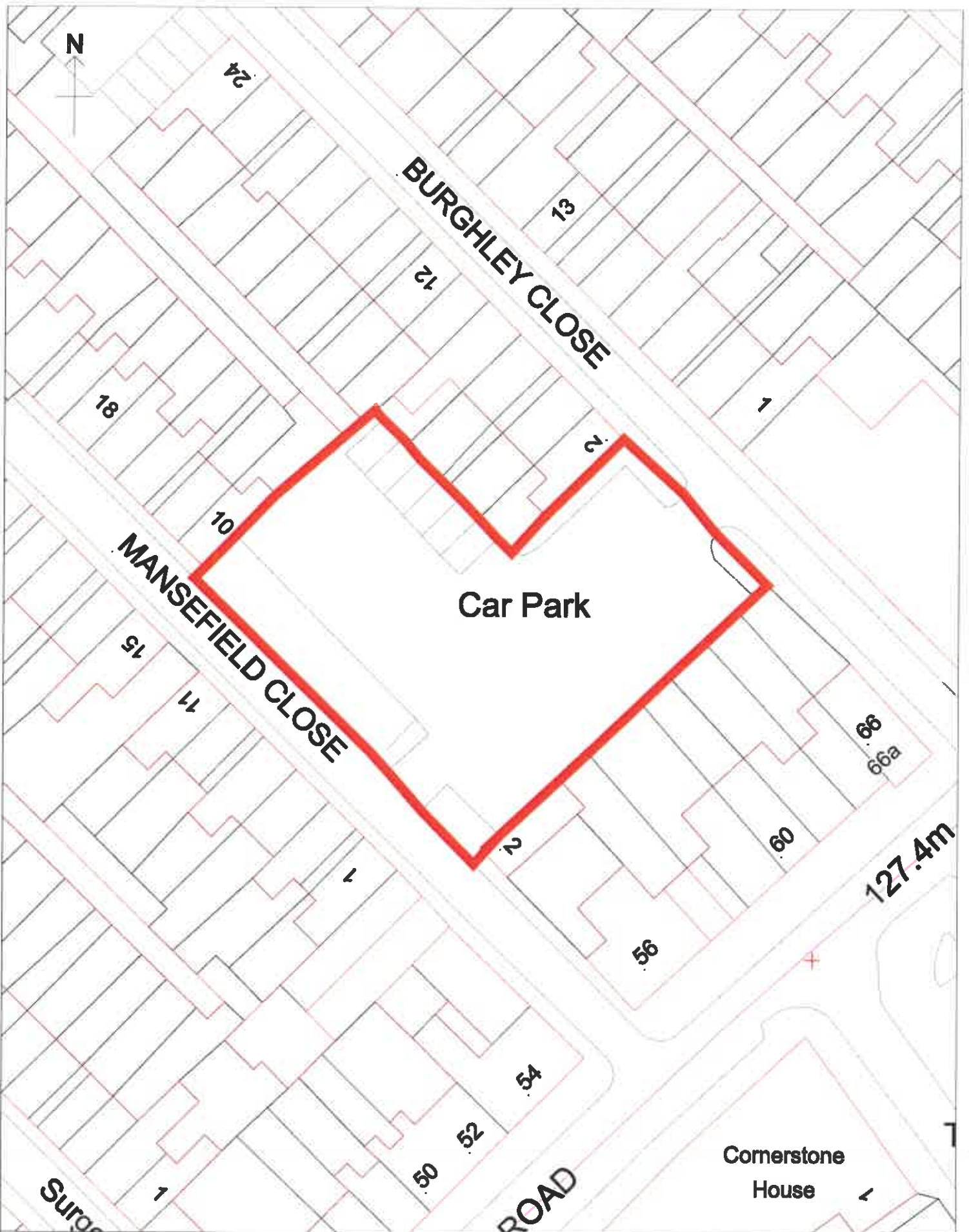

Title: Mansefield Close, Desborough Car Park

Reproduced by permission of Ordnance Survey on behalf of HMSO. © Crown Copyright 2020 All rights reserved.

Licence 100017647

Date: 22:01:20

Scale: 1:500

Drawn by: HGW

**Kettering**  
Borough Council

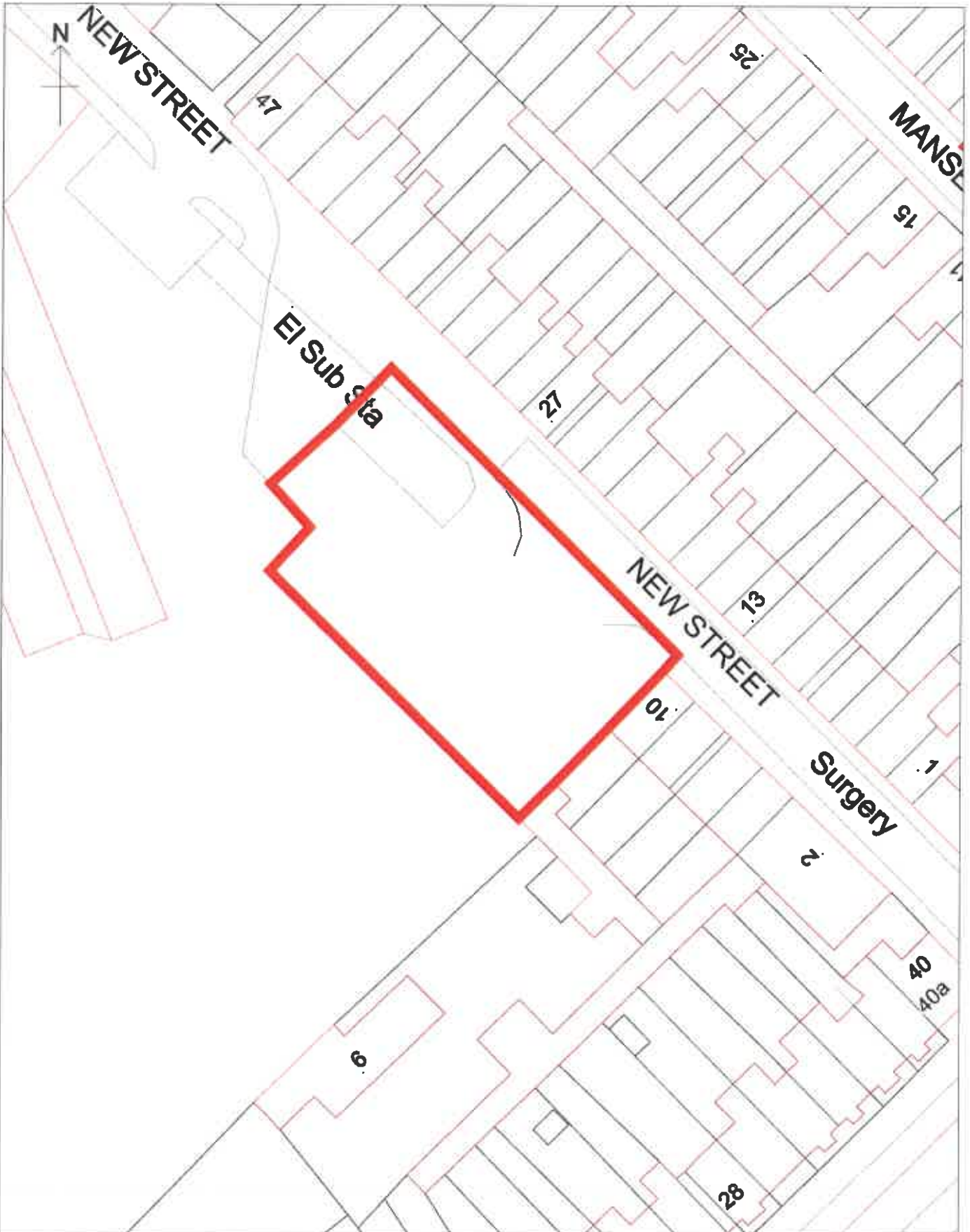

Title: New Street, Desborough

Reproduced by permission of Ordnance Survey on behalf of HMRC. © Crown Copyright 2020 All rights reserved.

Licence 100017847

**Kettering**  
Borough Council

Date: 21:01:20

Scale: 1:500

Drawn by: HGW

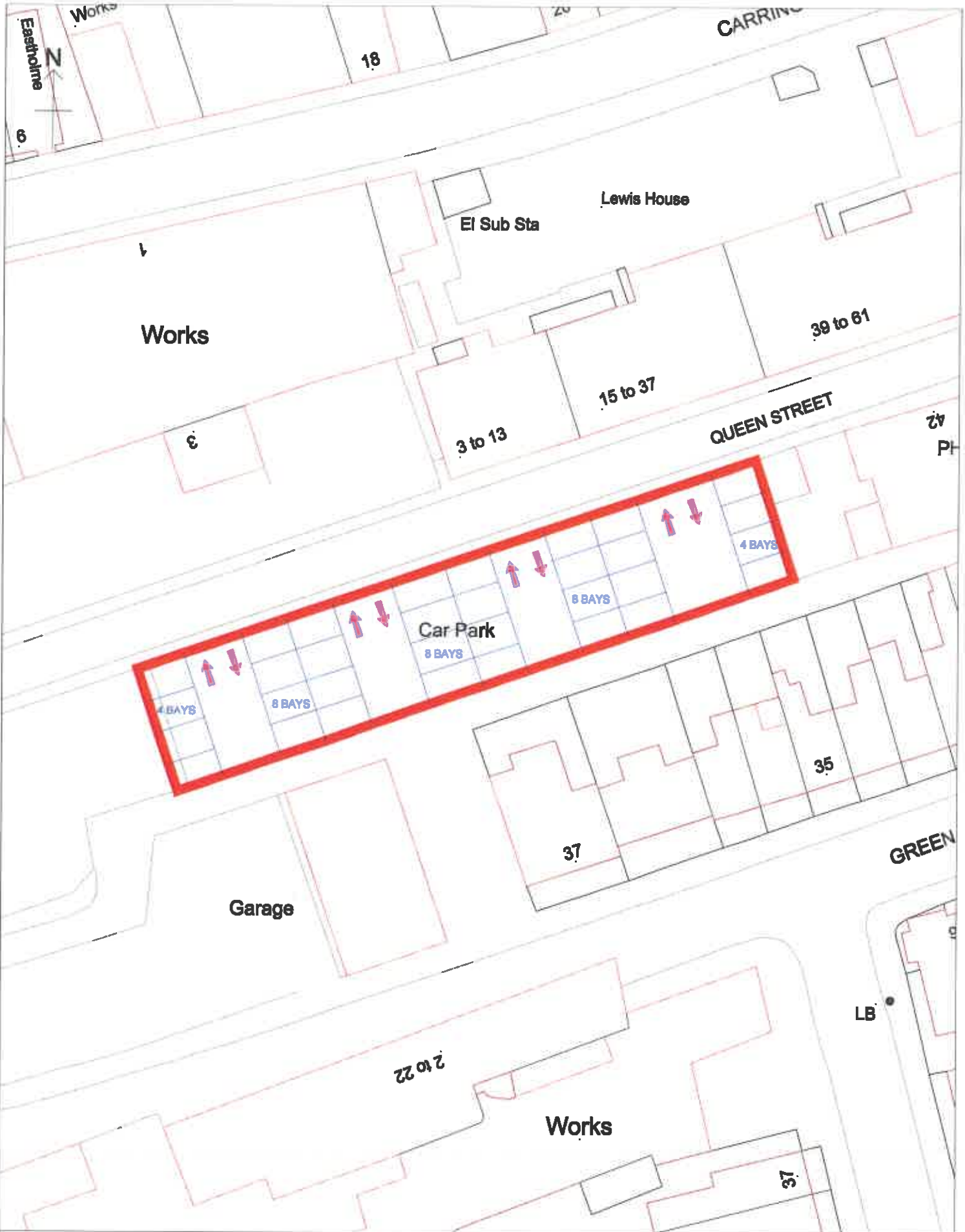

Title: Queen Street, Kettering

Reproduced by permission of Ordnance Survey on behalf of HMSO. © Crown Copyright 2020 All rights reserved.

Licence 100017847

Date: 21:01:20

Scale: 1:500

Drawn by: HGW

**Kettering**  
Borough Council

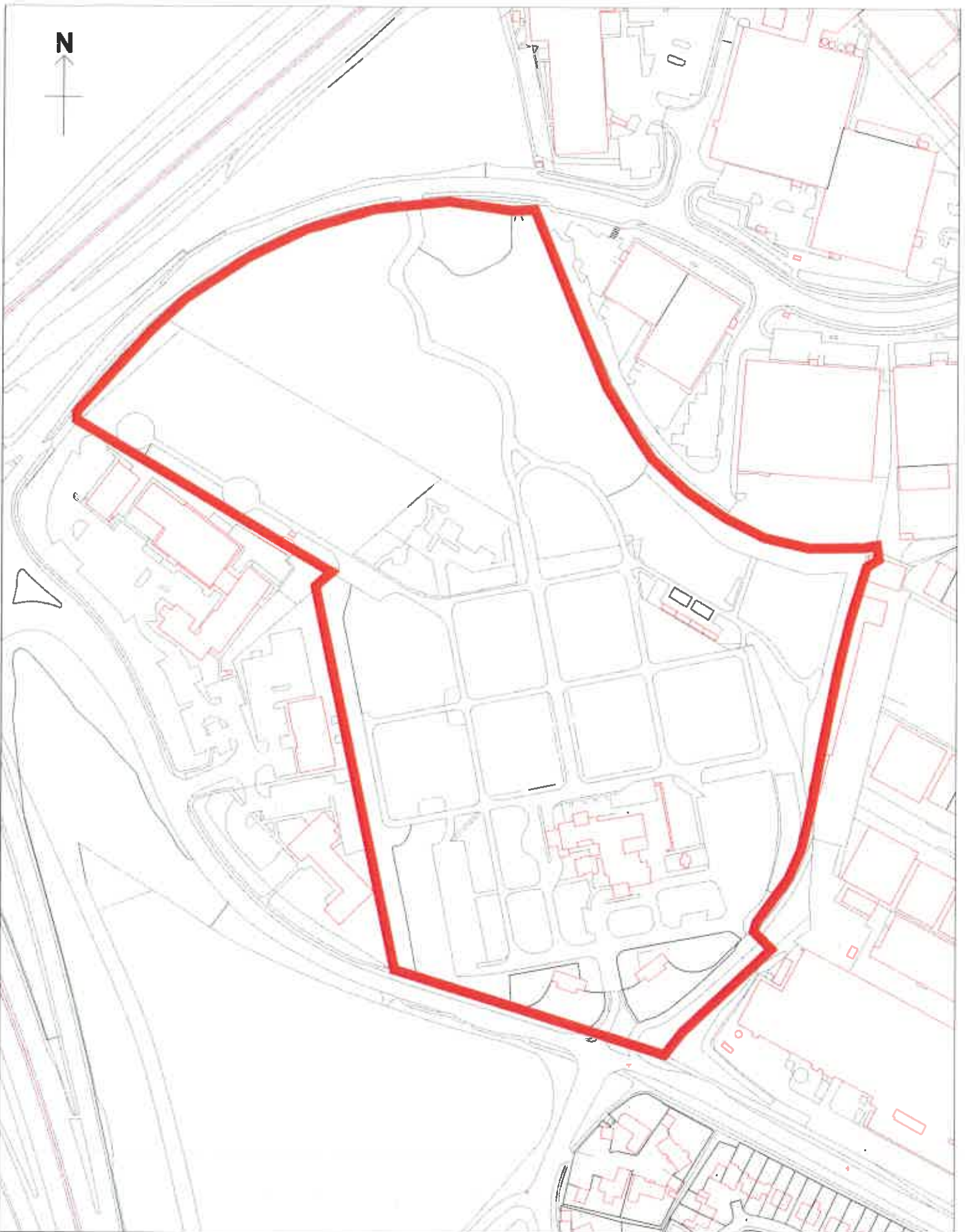

**Title: Rothwell Road Cemetery & Crematoria Car Parks**

Reproduced by permission of Ordnance Survey  
on behalf of HMSO. © Crown Copyright 2020  
All rights reserved.

Licence  
100017647

Date: 22:01:20

Scale: 1:2500

Drawn by: HGW

**Kettering**  
Borough Council

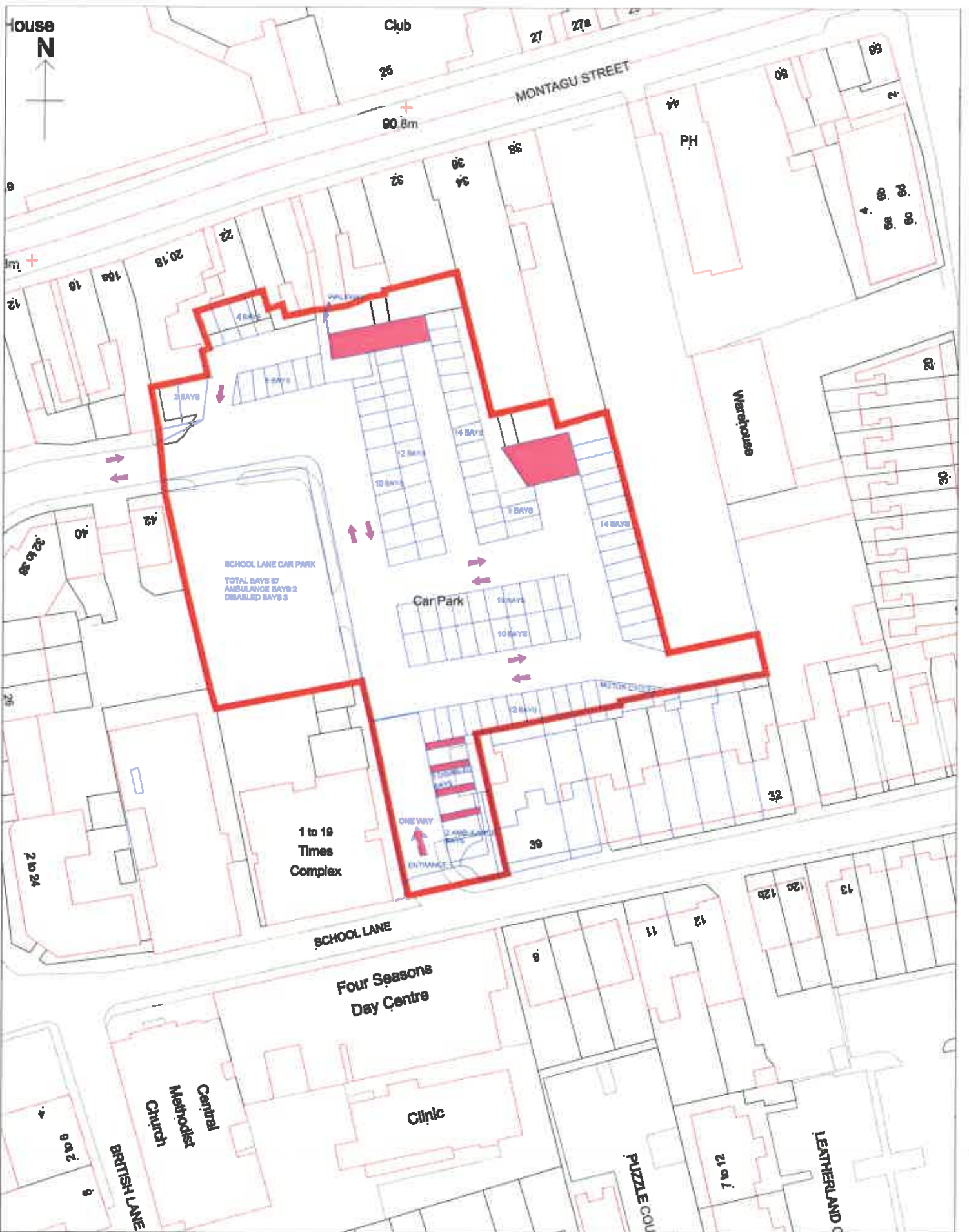

Title: School Lane, Kettering

Reproduced by permission of Ordnance Survey on behalf of HMSO. © Crown Copyright 2020 All rights reserved.

Licence 100017647

Date: 21:01:20

Scale: 1:750

Drawn by: HGW

**Kettering**  
Borough Council

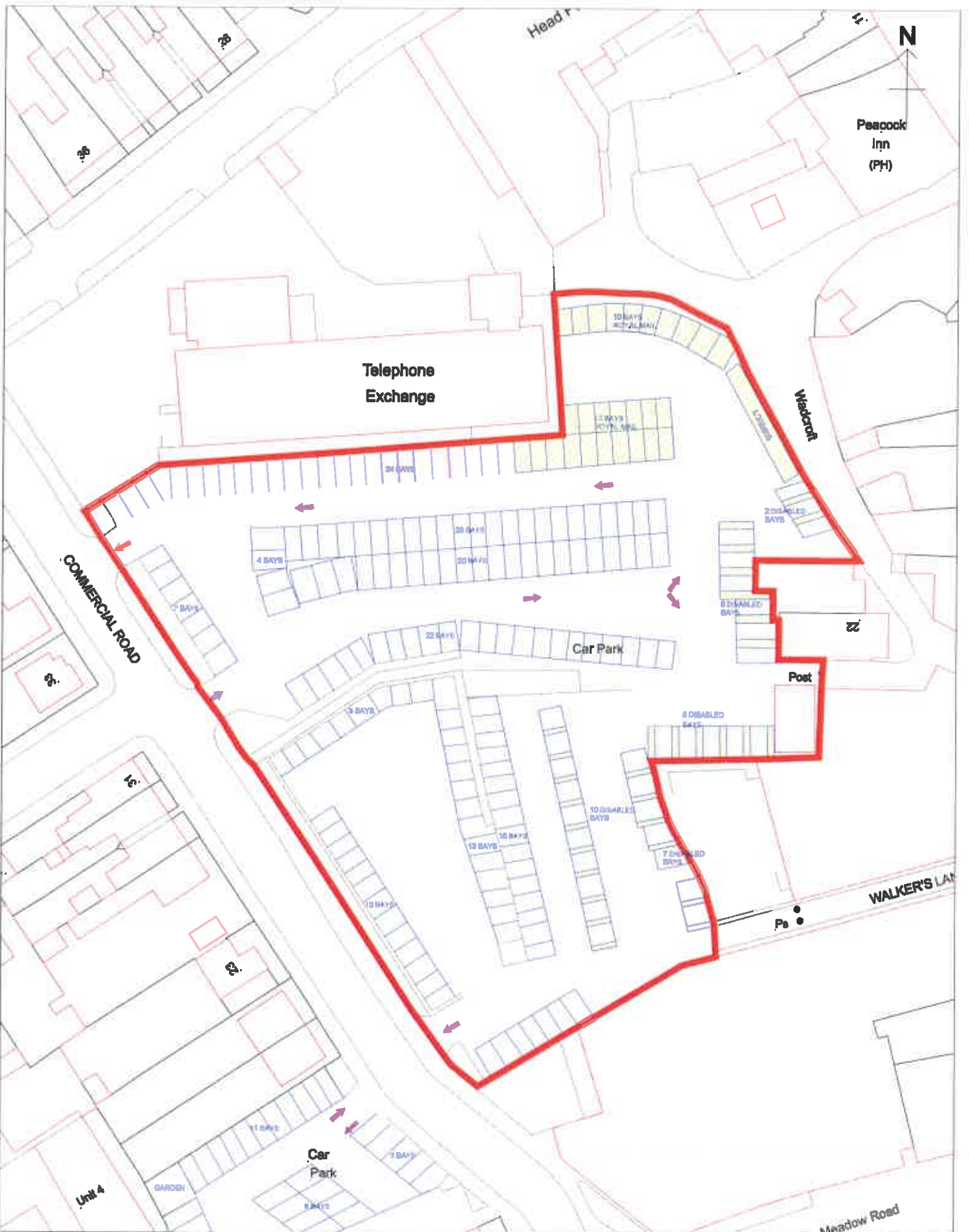

Title: 8498: Wadcroft Car Park

Reproduced by permission of Ordnance Survey on behalf of HMSO. © Crown Copyright 2020 All rights reserved.

Licence 100017847

Date: 23:01:20

Scale: 1:750

Drawn by: HGW

**Kettering**  
Borough Council

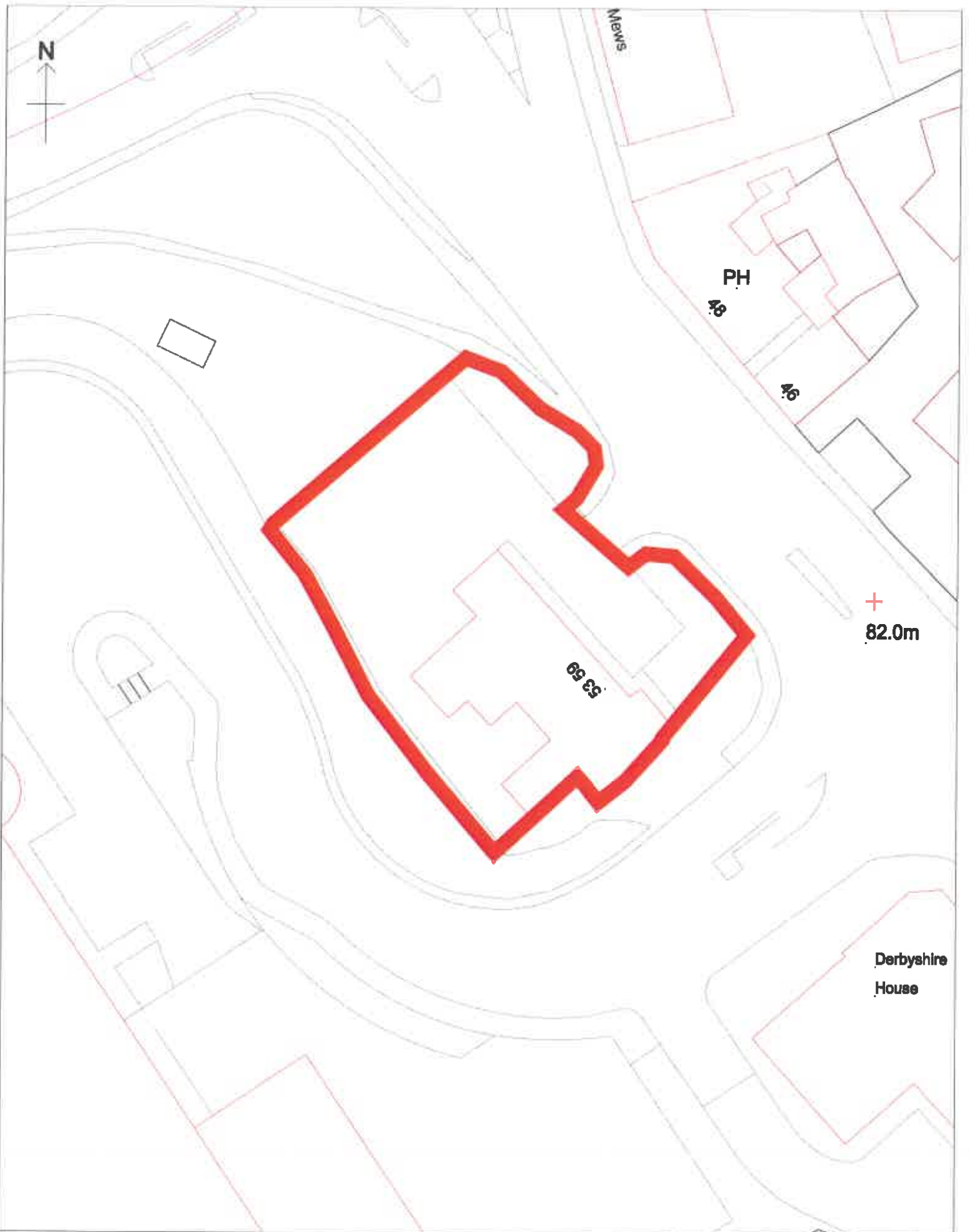

**Title: Chesham House Car Park**

Reproduced by permission of Ordnance Survey on behalf of HMSC. © Crown Copyright 2020 All rights reserved.

Licence  
100017647

**Kettering**  
Borough Council

Date: 22-01-20

Scale: 1:500

Drawn by: HGW



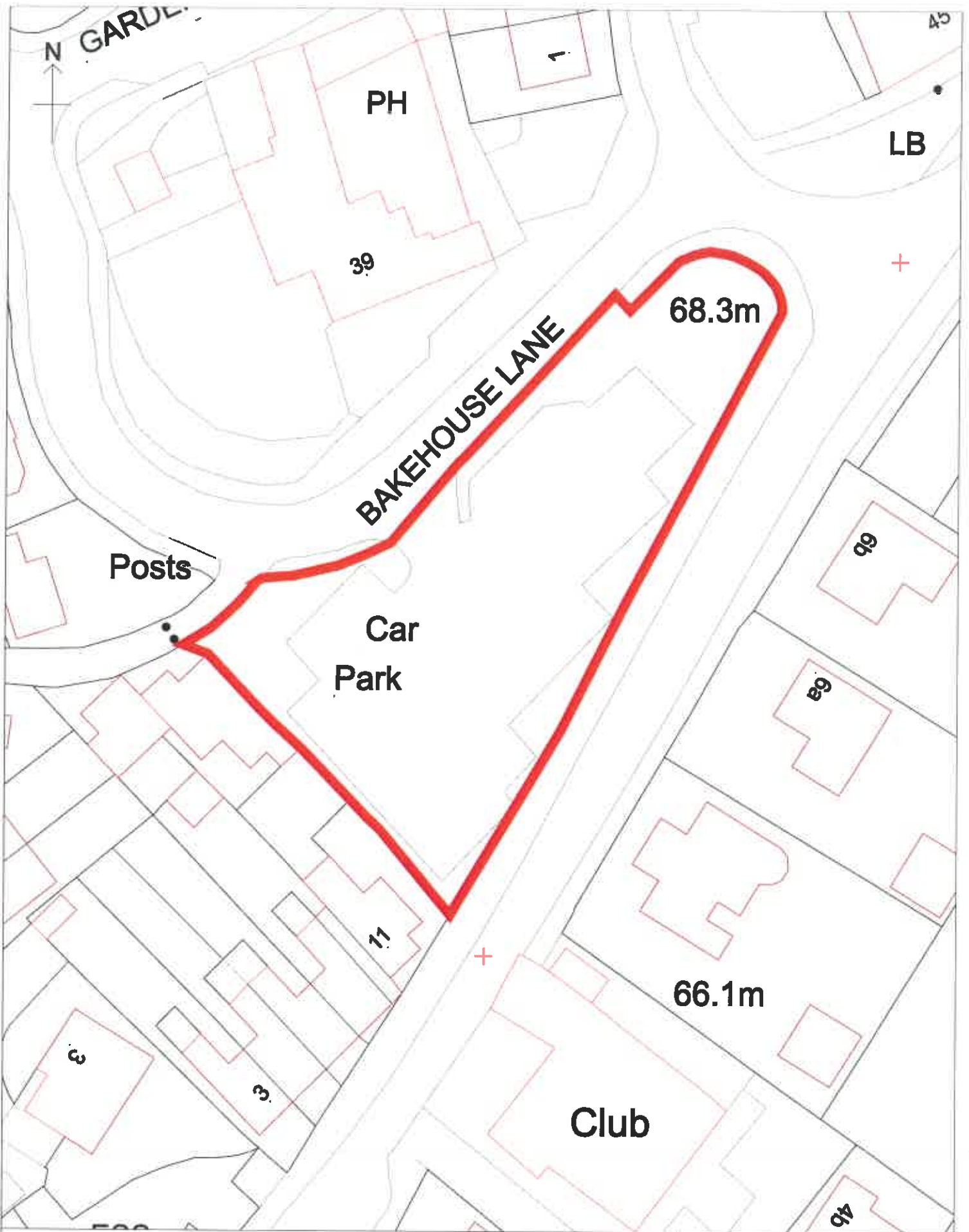

Title: Church Street, Burton Latimer

Reproduced by permission of Ordnance Survey on behalf of HMISO. © Crown Copyright 2020 All rights reserved.

Licence  
100017847

Date: 21:01:20

Scale: 1:500

Drawn by: HGW

**Kettering**  
Borough Council

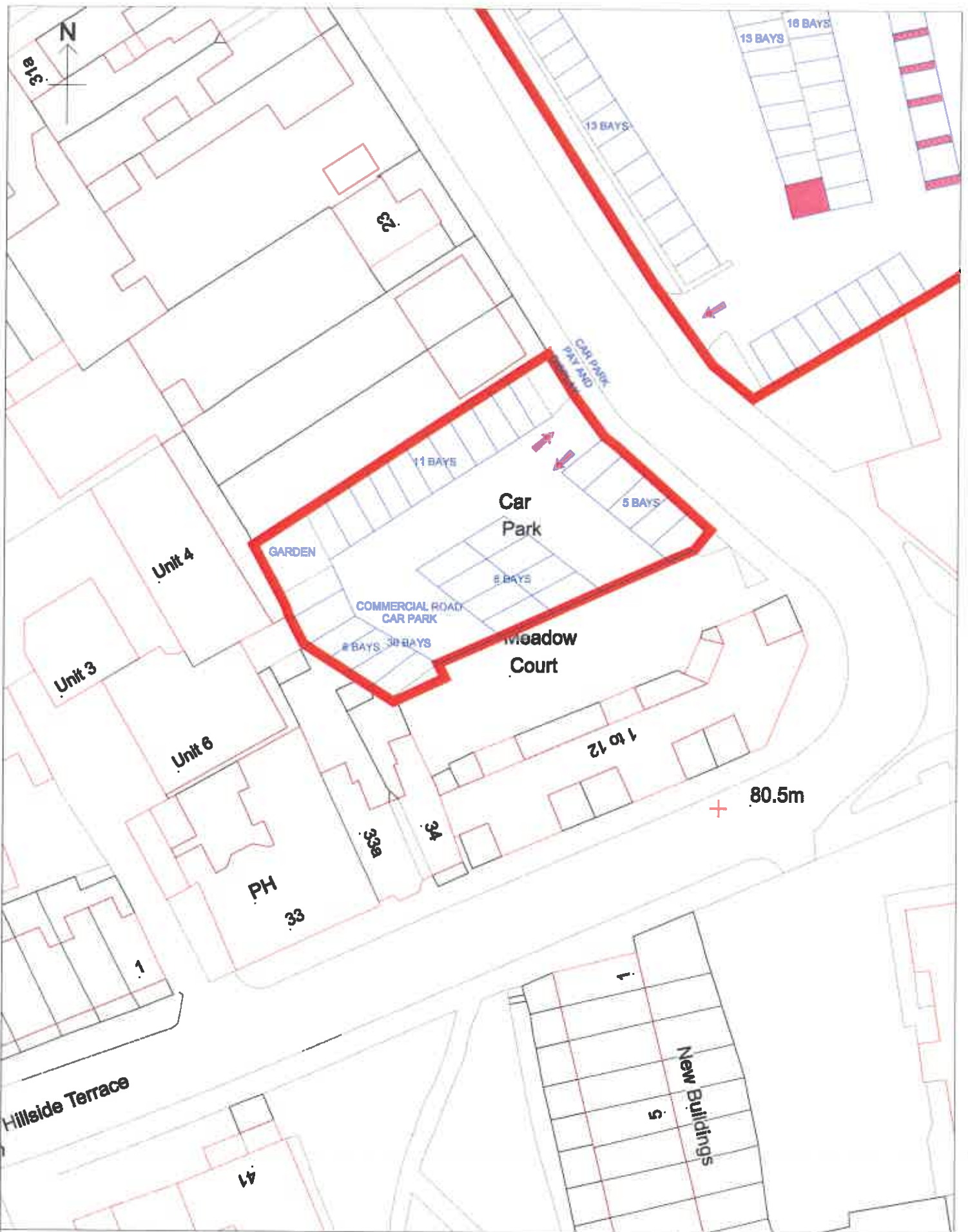

Title: Commercial Road

Reproduced by permission of Ordnance Survey on behalf of HMSO. © Crown Copyright 2020 All rights reserved.

Licence 100017647

Date: 21:01:20

Scale: 1:500

Drawn by: HGW

**Kettering**  
Borough Council

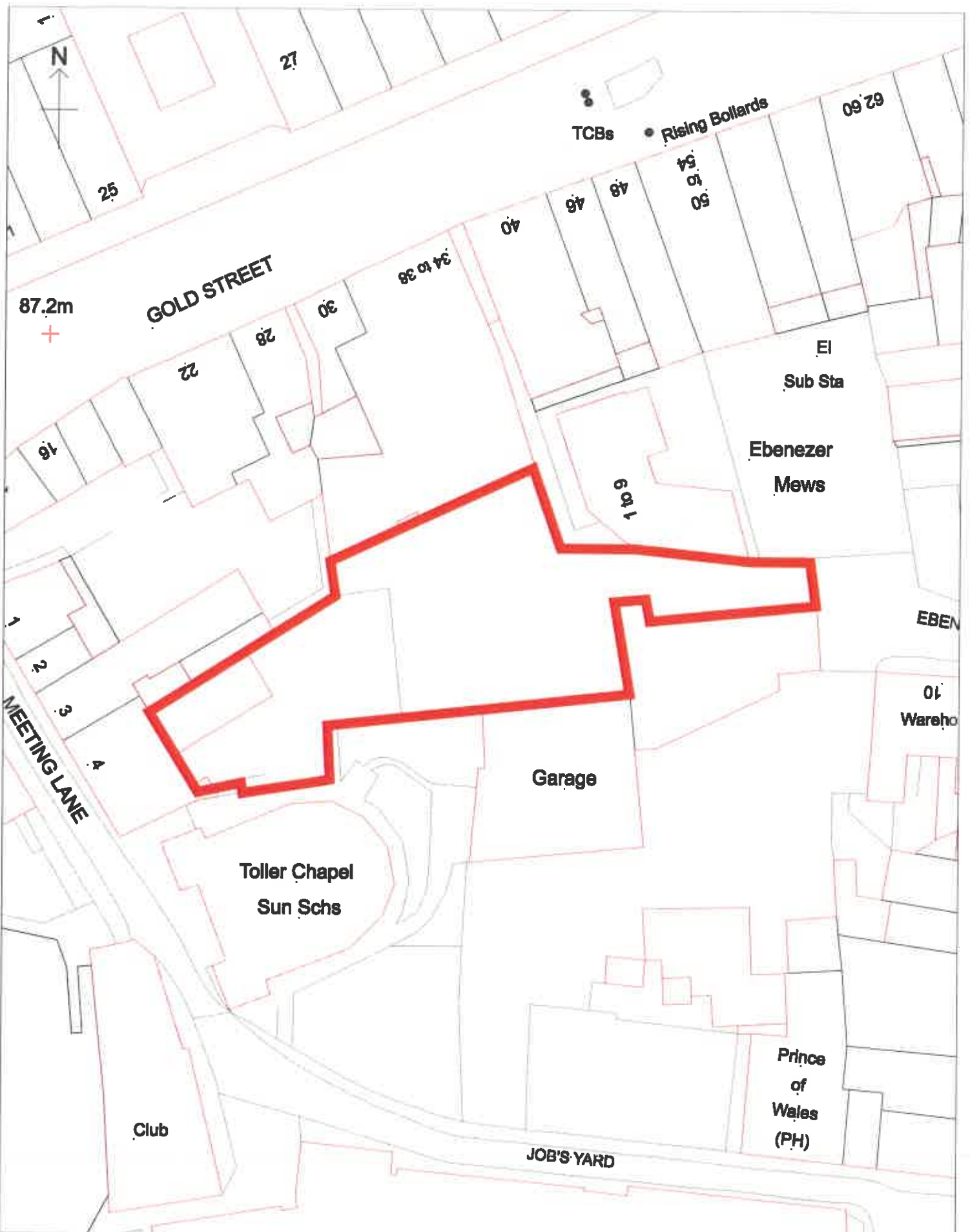

Title: Ebenezer Place Car Park

Reproduced by permission of Ordnance Survey on behalf of HMSO. © Crown Copyright 2020 All rights reserved.

Licence 100017847

Date: 22:01:20

Scale: 1:500

Drawn by: HGW

**Kettering**  
Borough Council

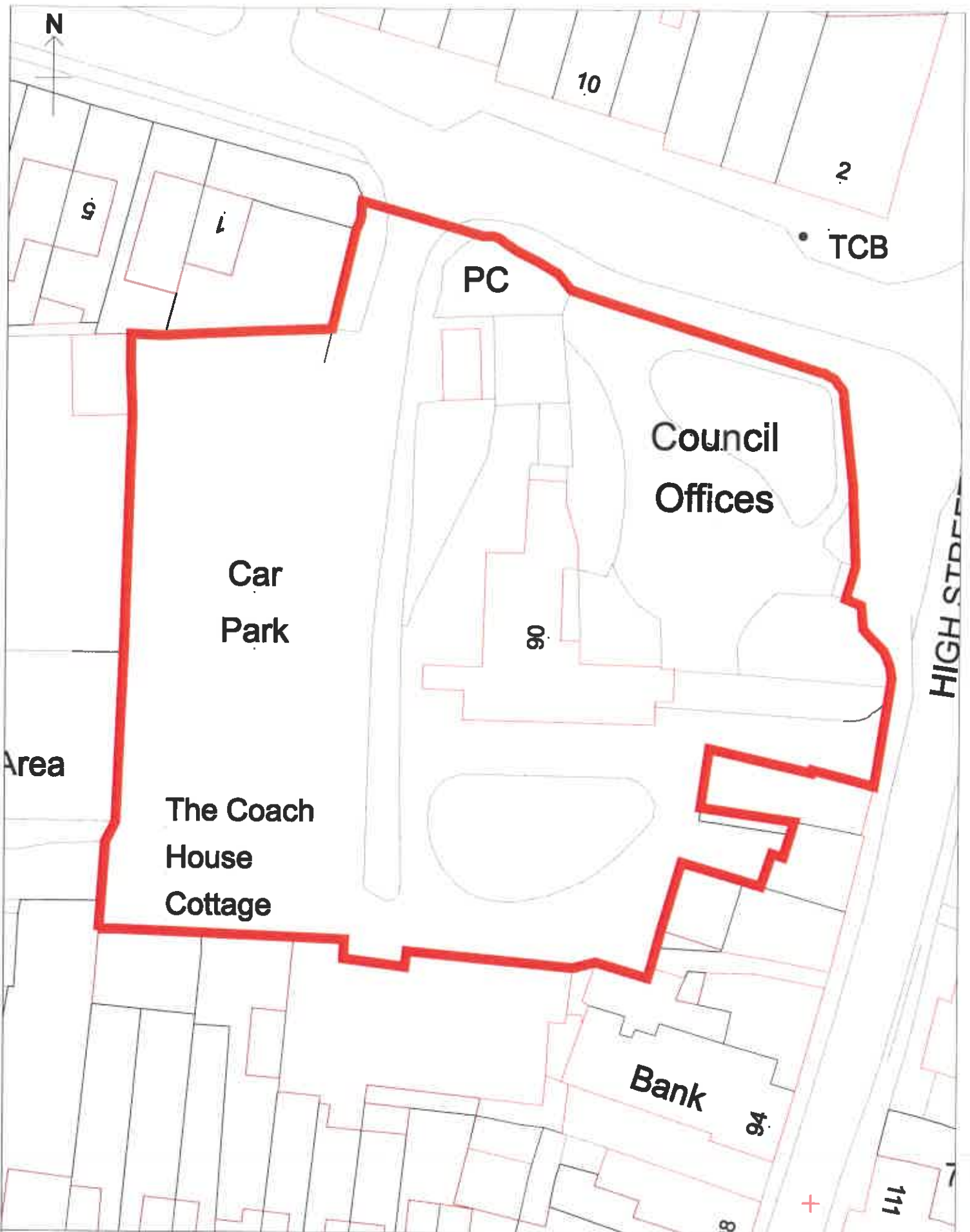

**Title:** Churchill Way, Burton Latimer

Reproduced by permission of Ordnance Survey on behalf of HMSO. © Crown Copyright 2020 All rights reserved.

Licence  
100017847

**Date:** 21:01:20

**Scale:** 1:500

**Drawn by:** HGW

**Kettering**  
Borough Council